

40 CD - WATERTIGHT ENCLOSURES - IP55

TECHNICAL CHARACTERISTICS

Standard: IEC 60670-1; IEC 60670-24; EN 60670-1; EN 60670-24

Degree of protection: IP55

Protection against indirect contact: double insulation - □ (•)

Installation temperature: max. +60°C; min. -25°C

Rated voltage: 400V

Rated insulation voltage: 1000 V in accordance to EN 62208 (both cc and dc)

Rated current: 125A

Material: technopolymer GW PLAST,

halogen-free in accordance with EN 60754-2 (CEI EN 50267-2-2).

Impact resistance: IK 09

Heat resistance: thermo-pressure with ball 70°C

Resistance to abnormal heat and fire: Glow wire test 650°C

(•) Complete insulation in accordance with EN 61140 Standard, obtainable with screwcaps (GW 44 623) or resin fixing brackets (GW 44 621).

BEHAVIOUR WITH CHEMICAL AND ATMOSPHERIC AGENTS

Saline solution	Acids		Bases		Solvents				Mineral oil	UV rays
	Concentrated	Diluted	Concentrated	Diluted	Hexane	Benzol	Acetone	Ethyl alcohol		
Resistant	Not resistant	Limited resistance	Not resistant	Limited resistance	Limited resistance	Not resistant	Not resistant	Limited resistance	Limited resistance	Resistant

ENCLOSURES

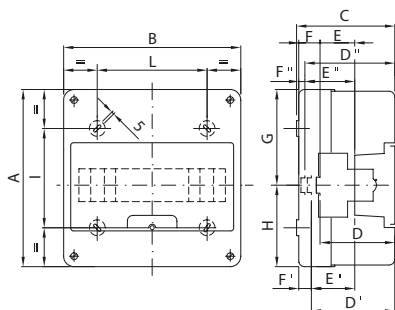

	Code	Overall dimensions			Modular assembly											Fixing		
		A	B	C	D	E	F	G	H	D'	E'	F'	D''	E''	F''	NR	I	L
4M	GW 40 001	170	105	98	74	48.5	17.5	85	85	-	-	-	-	-	-	2	115	-
8M	GW 40 003	180	180	98	74	48.5	17.5	95	85	-	-	-	-	-	-	3	110	110
12M	GW 40 005	250	250	135.5	96	47	32	135	115	106	57	22	117.5	68.5	10.5	4	140	155

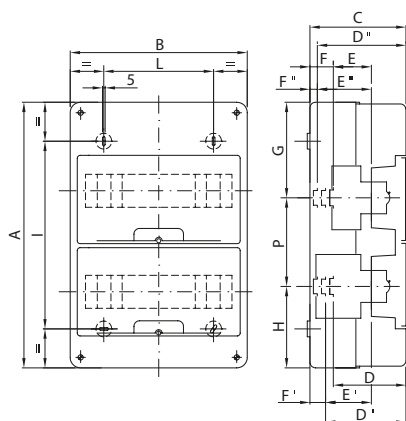

	Code	Overall dimensions			Modular assembly												Fixing		
		A	B	C	D	E	F	G	H	P	D'	E'	F'	D''	E''	F''	NR	I	L
24M	GW 40 007	375	250	135.5	96	47	32	135	115	125	106	57	22	117.5	68.5	10.5	4	265	155
36M	GW 40 009	400	376	135.5	96	47	32	135	115	150	106	57	22	117.5	68.5	10.5	4	320	295