

Markspett Spot It Multi Förlängningsarm Spot It Multi

hidealite

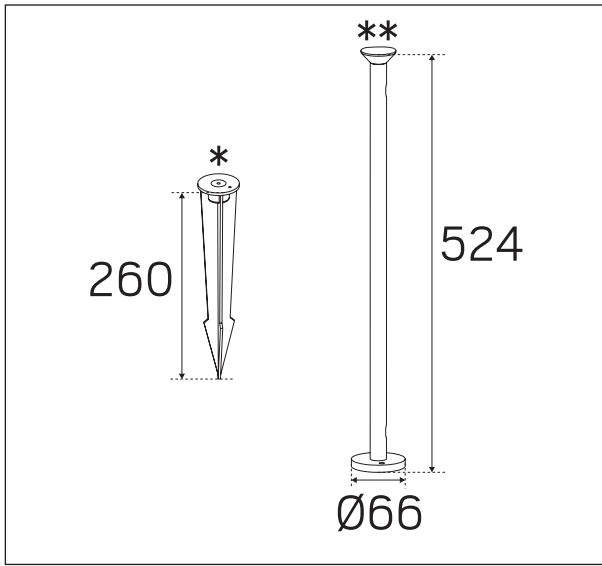

E-nr, Snro, El.nr	Name	Works with
77 623 95, 45 234 09 , 31 053 39	*Markspett Spot It Multi	Spot It Multi 1, 3, 7 & 17
77 623 96, 45 234 10 , 31 053 42	**Förlängningsarm Spot It Multi	Spot It Multi 1, 3 & 7 (not for Spot It Multi 17)



For explanation of symbols see www.hidealite.se

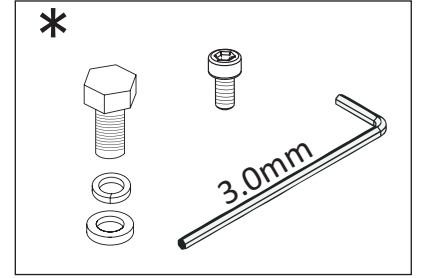
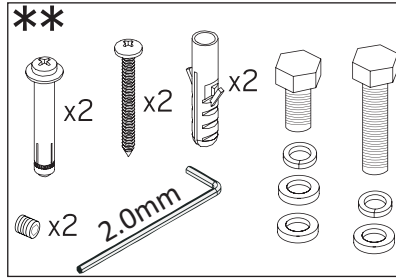

A

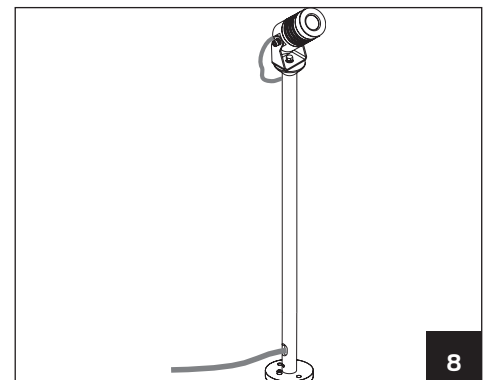
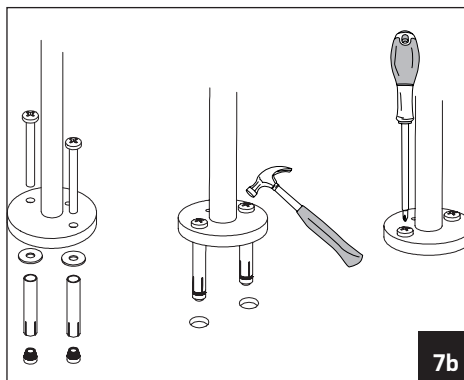
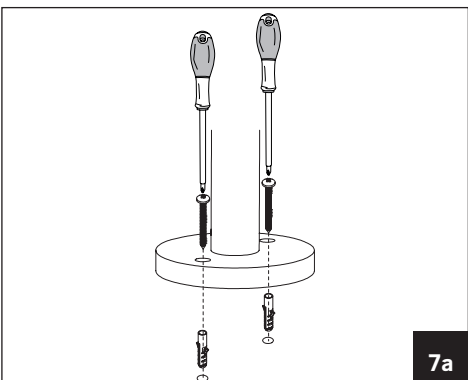
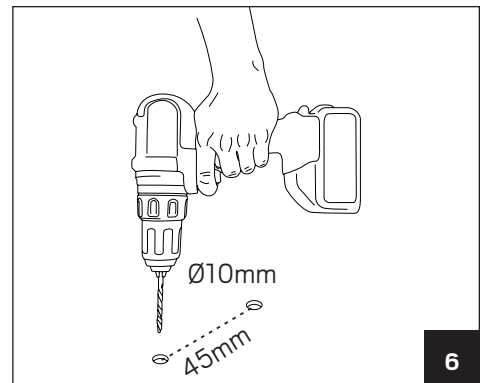
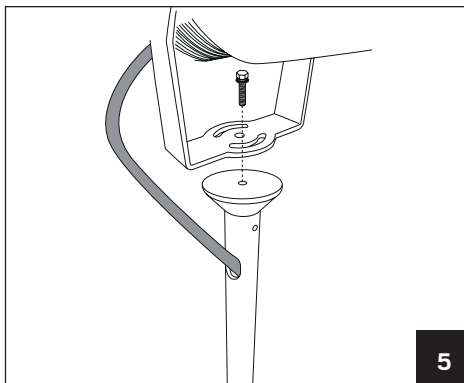
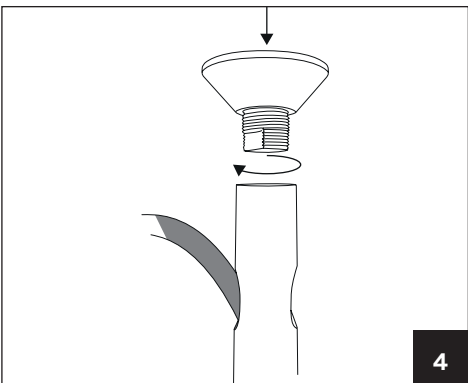
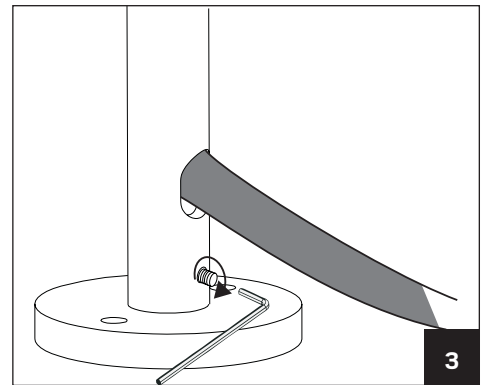
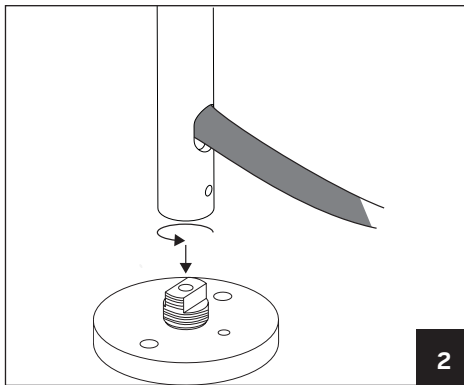
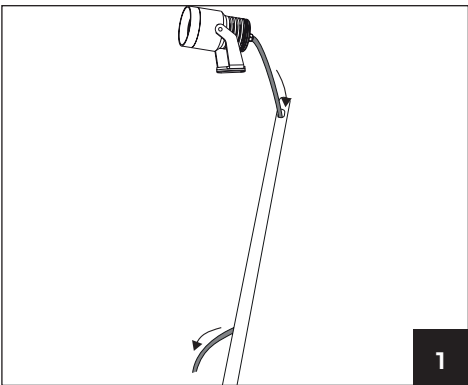

B

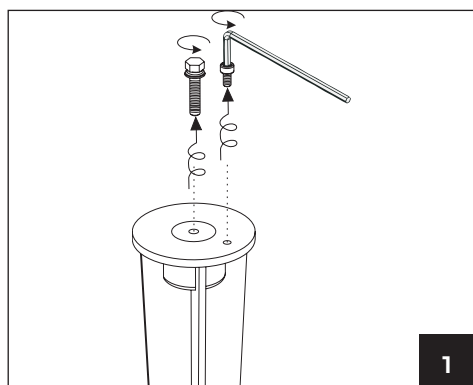

1

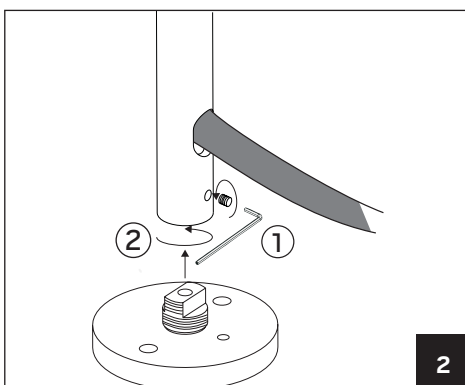

2

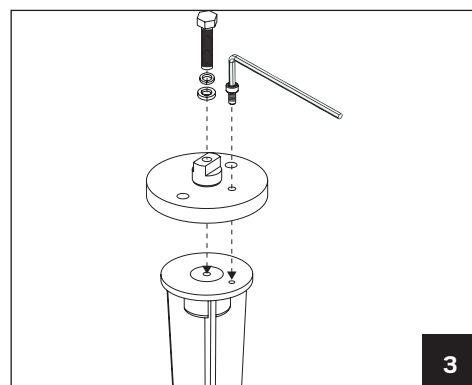

3

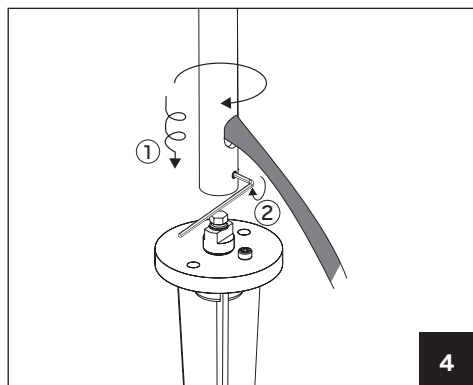

4

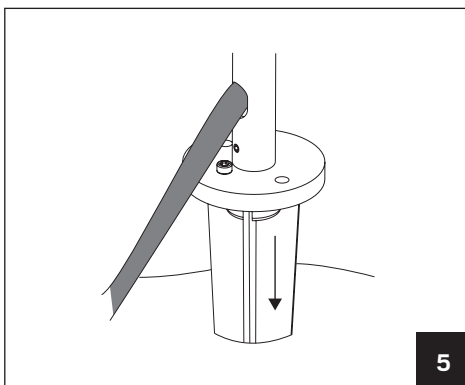

5

C

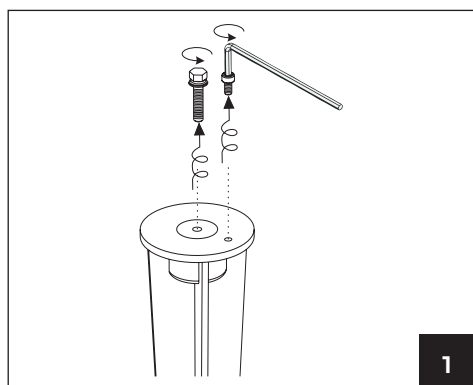

1

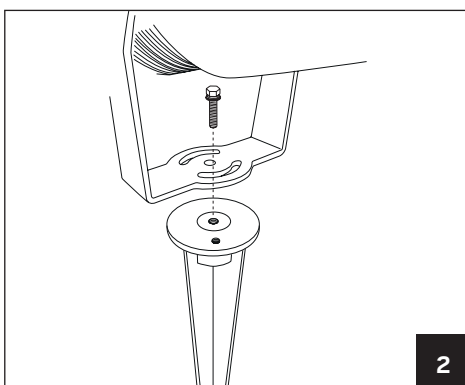

2

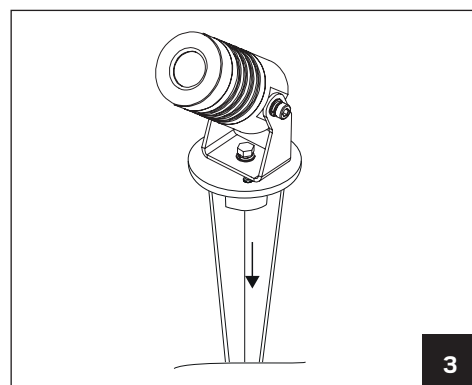

3

SV

SÄKER INSTALLATION

Läs dessa instruktioner före installationen påbörjas och lämna den vidare till brukaren av anläggningen. Armaturen skall installeras av behörig installatör och enligt gällande föreskrifter. Se till att spänningen är fränslagen före installation eller underhåll. Installera armaturen enligt beskrivningen.

A Armatur monterad på förlängningsarm

B Förlängningsarm monterad på spett

C Armatur monterad på spett

en

SAFETY INSTRUCTIONS

Read these instructions carefully before commencing installation and retain for future reference. The luminaire should be installed by a licensed electrician and in accordance with local regulations. Make sure that the power is off before installation or maintenance. Install as described.

A Luminaire mounted on the extension arm

B Extension arm mounted on a skewer

C Luminaire mounted on skewers

fi

TURVALLISUUSOHJEET

Lue nämä ohjeet ennen asentamista ja luovuta ohjeet valaisimen seuraavalle käyttäjälle. Valaisimen saa asentaa valtuutettu asentaja voimassa olevien määräysten mukaisesti. Varmista, että jännite on kytketty päältä ennen asennusta ja huoltoa. Asenna valaisin alla olevien piirustusten mukaisesti.

A Valaisin asennettuna jatkoputkeen

B Jatkoputki asennettuna maapiikkiin

C Valaisin asennettuna maapiikkiin

no

SIKKER INSTALLERING

Les disse instruksjonene før du starter installeringen, og gi den deretter videre til anleggets bruker. Armaturen skal installeres av en godkjent installatør og i henhold til gjeldende lover og regler. Sørg for at strømmen er koblet fra før installering og ved vedlikehold. Installer i henhold til beskrivelsen.

A Armatur montert på forlengerarm

B Forlengerarm montert på jordspyd

C Armatur montert på jordspyd