

CV Power supplies 24 V



Product family features

- Type of protection: IP20
- Wide operating temperature range: -20...+50 °C
- Lifetime: up to 50,000 h (temperature at max. t_c)

Product family benefits

- Installation in cold and hot environments
- Very stable output power
- High electronical reversible short-circuit, overload, overtemperature protection
- Independent installation possible

Areas of application

- Facades, public squares, cruise ships
- Signage
- Suitable for indoor and outdoor installations

Product family datasheet

Technical data

Product description	Electrical data					
	Nominal input voltage	Mains frequency	Input voltage AC	Input voltage DC	Total harmonic distortion	Power factor λ
OT SLIM 30/220-240/24	220...240 V	50...60 Hz	195.5...276 V	176...250 V	< 5 %	> 0.95
OT SLIM 60/220-240/24	220...240 V	50...60 Hz	195.5...276 V	176...250 V	< 5 %	> 0.95
OT SLIM 100/220-240/24	220...240 V	50...60 Hz	195.5...276 V	176...250 V	< 5 %	> 0.95
OT SLIM 160/220-240/24	220...240 V	50...60 Hz	195.5...276 V	176...250 V	< 5 %	> 0.95
OT SLIM 250/220-240/24	220...240 V	50...60 Hz	195.5...276 V	176...250 V	< 5 %	> 0.95
OT 6/200...240/24 CE	200...240 V	50...60 Hz	180...264 V ²⁾			0.50 ³⁾
OT 20/220...240/24	220...240 V	50...60 Hz	198...264 V ²⁾	-	150 %	0.50 ³⁾

Product description	ECG efficiency	Device power loss	Inrush current	Max. ECG no. on circuit breaker 10 A (C)	Max. ECG no. on circuit breaker 16 A (B)	Max. ECG no. on circuit breaker 16 A (C)
OT SLIM 30/220-240/24	86 %	4.9 W	30 A	15	14	23
OT SLIM 60/220-240/24	88 %	8.2 W	40 A	11	10	17
OT SLIM 100/220-240/24	91 %	9.9 W	50 A	6	6	10
OT SLIM 160/220-240/24	92 %	13.9 W	60 A			5
OT SLIM 250/220-240/24	92 %	28 W	70 A			
OT 6/200...240/24 CE	80 %	1.5 W ⁴⁾	15 A ⁵⁾		48	
OT 20/220...240/24	83 %	4.0 W ¹¹⁾	17 A	-	42	-

Product description	Max. ECG no. on circuit breaker 25 A (B)	Surge capability (L-N)	Nominal output voltage	U-OUT (working voltage)	Nominal output power
OT SLIM 30/220-240/24	22	1 kV	24.2 V	24 V	30 W
OT SLIM 60/220-240/24	16	1 kV	24.2 V	24 V	60 W
OT SLIM 100/220-240/24	10	1 kV	24.2 V	24 V	100 W
OT SLIM 160/220-240/24	5	1 kV	24.2 V	24 V	160 W
OT SLIM 250/220-240/24		1 kV	24.2 V	24 V	250 W
OT 6/200...240/24 CE	-	1 kV	24 V ⁶⁾	25 V	6 W ⁷⁾
OT 20/220...240/24	-	1 kV	24 V ¹²⁾	24 V	20 W ¹³⁾

Product description	Galvanic isolation	Output ripple Voltage (100 Hz)	Max. ECG no. on circuit breaker 10 A (B)	Galvanic isolation primary/secondary	Surge capability (L/N-Ground)
OT SLIM 30/220-240/24	SELV	± 5 %			
OT SLIM 60/220-240/24	SELV	± 5 %			
OT SLIM 100/220-240/24	SELV	± 5 %			
OT SLIM 160/220-240/24	SELV	± 5 %			
OT SLIM 250/220-240/24	SELV	± 5 %			

Product family datasheet

Product description	Galvanic isolation	Output ripple Voltage (100 Hz)	Max. ECG no. on circuit breaker 10 A (B)	Galvanic isolation primary/secondary	Surge capability (L/N-Ground)
OT 6/200...240/24 CE	SELV		30	3 kV	
OT 20/220...240/24	SELV	-	23	3 kV	-

Product description	Dimensions & weight				
	Mounting hole spacing, length	Product weight	Cable cross-section, input side	Cable cross-section, output side	Wire preparation length, input side
OT SLIM 30/220-240/24	222.0 mm	120.00 g	0.75...1.5 mm ²	0.75...1.5 mm ²	5.0 mm
OT SLIM 60/220-240/24	290.0 mm	170.00 g	0.75...1.5 mm ²	0.75...1.5 mm ²	5.0 mm
OT SLIM 100/220-240/24	326.0 mm	220.00 g	0.75...1.5 mm ²	0.75...1.5 mm ²	5.0 mm
OT SLIM 160/220-240/24	356.0 mm	285.00 g	0.75...1.5 mm ²	0.75...1.5 mm ²	5.0 mm
OT SLIM 250/220-240/24	295.0 mm	880.00 g	0.75...1.5 mm ²	0.75...1.5 mm ²	5.0 mm
OT 6/200...240/24 CE		52.00 g	1.0 mm ²	1.0 mm ²	10 mm
OT 20/220...240/24	-	108.00 g	0.75...1.5 mm ²	0.5...1.5 mm ²	10 mm

Product description	Wire preparation length, output side	Height	Width	Length	Cable/wire length, input side
OT SLIM 30/220-240/24	5.0 mm	17.5 mm	30.0 mm	270.0 mm	
OT SLIM 60/220-240/24	5.0 mm	17.5 mm	30.0 mm	338.0 mm	
OT SLIM 100/220-240/24	5.0 mm	18.5 mm	30.0 mm	374.0 mm	
OT SLIM 160/220-240/24	5.0 mm	21.5 mm	30.0 mm	404.0 mm	
OT SLIM 250/220-240/24	5.0 mm	31.0 mm	60.0 mm	343.0 mm	
OT 6/200...240/24 CE	10 mm	22.0 mm	50.0 mm	51.0 mm	185 mm
OT 20/220...240/24	10 mm	35.0 mm	50.0 mm	109.0 mm	-

Product description	Cable/wire length, output side	Colors & materials	Temperatures & operating conditions	
		Casing material	Ambient temperature range	Maximum temperature at tc test point
OT SLIM 30/220-240/24		Plastic	-25...+45 °C	75 °C
OT SLIM 60/220-240/24		Plastic	-25...+45 °C	70 °C
OT SLIM 100/220-240/24		Plastic	-25...+45 °C	80 °C
OT SLIM 160/220-240/24		Plastic	-25...+45 °C	75 °C
OT SLIM 250/220-240/24		Plastic	-25...+45 °C	80 °C
OT 6/200...240/24 CE	135 mm	Plastic	-20...+50 °C	70 °C
OT 20/220...240/24	-	Plastic	-20...+50 °C	70 °C

Product family datasheet

Product description	Max.housing temperature in case of fault	Temperature range at storage	Permitted rel. humidity during operation	Lifespan	Capabilities
				ECG lifetime	Dimmable
OT SLIM 30/220-240/24	110 °C	-40...+85 °C	5...85 % ¹⁾	50000 h	No
OT SLIM 60/220-240/24	110 °C	-40...+85 °C	5...85 % ¹⁾	50000 h	No
OT SLIM 100/220-240/24	110 °C	-40...+85 °C	5...85 % ¹⁾	50000 h	No
OT SLIM 160/220-240/24	110 °C	-40...+85 °C	5...85 % ¹⁾	50000 h	No
OT SLIM 250/220-240/24	110 °C	-40...+85 °C	5...85 % ¹⁾	50000 h	No
OT 6/200...240/24 CE	100 °C	-40...+85 °C	5...85 % ¹⁾	50000 h ⁸⁾	No ⁹⁾
OT 20/220...240/24	90 °C	-40...+85 °C	5...85 % ¹⁾	30000 h	No ⁹⁾

Product description	Dimming interface	Dimming range	Overload protection	Short-circuit protection
OT SLIM 30/220-240/24	-	-	Automatic reversible	Automatic reversible
OT SLIM 60/220-240/24	-	-	Automatic reversible	Automatic reversible
OT SLIM 100/220-240/24	-	-	Automatic reversible	Automatic reversible
OT SLIM 160/220-240/24	-	-	Automatic reversible	Automatic reversible
OT SLIM 250/220-240/24	-	-	Automatic reversible	Automatic reversible
OT 6/200...240/24 CE			Automatic reversible	Automatic reversible
OT 20/220...240/24	-	-	Automatic reversible	Automatic reversible

Product description	No-load proof	Suitable for fixtures with prot. class	Type of connection, input side	Type of connection, output side
OT SLIM 30/220-240/24	-	I / II	Screw terminal	Screw terminal
OT SLIM 60/220-240/24	-	I / II	Screw terminal	Screw terminal
OT SLIM 100/220-240/24	-	I / II	Screw terminal	Screw terminal
OT SLIM 160/220-240/24	-	I / II	Screw terminal	Screw terminal
OT SLIM 250/220-240/24	-	I / II	Screw terminal	Screw terminal
OT 6/200...240/24 CE	Yes	II		
OT 20/220...240/24	Yes	II		Screw terminal

Product family datasheet

Product description	Overheating protection	Number of channels	Certificates & standards	
			Approval marks – approval	Standards
OT SLIM 30/220-240/24			CE / CB / ENEC / CCC / EAC / RCM / BIS	Acc. to IEC 61347-2-13/Acc. to IEC 62384/Acc. to EN 55015/Acc. to IEC 61000-3-2/Acc. to IEC 61000-3-3
OT SLIM 60/220-240/24			CE / CB / ENEC / CCC / EAC / RCM / BIS	Acc. to IEC 61347-2-13/Acc. to IEC 62384/Acc. to EN 55015/Acc. to IEC 61000-3-2/Acc. to IEC 61000-3-3
OT SLIM 100/220-240/24			CE / CB / ENEC / CCC / EAC / RCM / BIS	Acc. to IEC 61347-2-13/Acc. to IEC 62384/Acc. to EN 55015/Acc. to IEC 61000-3-2/Acc. to IEC 61000-3-3
OT SLIM 160/220-240/24			CE / CB / ENEC / CCC / EAC / RCM / BIS	Acc. to IEC 61347-2-13/Acc. to IEC 62384/Acc. to EN 55015/Acc. to IEC 61000-3-2/Acc. to IEC 61000-3-3
OT SLIM 250/220-240/24			CE / CB / ENEC / CCC / EAC / RCM / BIS	Acc. to IEC 61347-2-13/Acc. to IEC 62384/Acc. to EN 55015/Acc. to IEC 61000-3-2/Acc. to IEC 61000-3-3
OT 6/200...240/24 CE	Automatic reversible		CE / VDE / ENEC 10 / CB	Acc. to IEC 61347-2-13/Acc. to IEC 62384/Acc. to EN 55015/Acc. to IEC 61000-3-2/Acc. to IEC 61000-3-3/Acc. to IEC 61547 ¹⁰⁾
OT 20/220...240/24	Automatic reversible	1	CE / ENEC 10 / VDE / VDE-EMC / RCM	Acc. to IEC 61347-2-13/Acc. to IEC 62384/Acc. to EN 55015/Acc. to IEC 61000-3-2/Acc. to IEC 61000-3-3/Acc. to IEC 61547

Product description	Protection class	Type of protection	Logistical data
			Commodity code
OT SLIM 30/220-240/24	II	IP20	850440829000
OT SLIM 60/220-240/24	II	IP20	850440829000
OT SLIM 100/220-240/24	II	IP20	850440829000
OT SLIM 160/220-240/24	II	IP20	850440829000
OT SLIM 250/220-240/24	II	IP20	850440829000

Product family datasheet

Product description	Protection class	Type of protection	Logistical data
			Commodity code
OT 6/200...240/24 CE	II	IP65	850440829000
OT 20/220...240/24	II	IP20	850440829000

1) Maximum 56 days/year at 85 %

2) Permitted voltage range

3) Minimum

4) Maximum at 230 V_{AC}, P_{out} = maximum, Ta=25 °C, steady state

5) At 240 V_{AC}

6) ±0.8 V

7) Partial load 0.9...6 W

8) At T_{case} = 60°C at T_c point / 10% failure rate

9) With OPTOTRONIC dimmers

10) Secondary switching not allowed

11) Maximum

12) ±1.0 V

13) Partial load 0.5...20 W

Product family datasheet

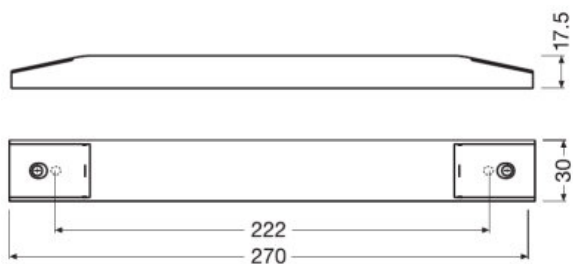

OT SLIM 30

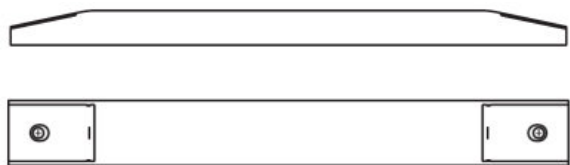

OT SLIM 30

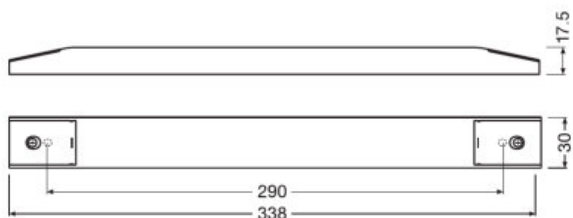

OT SLIM 60

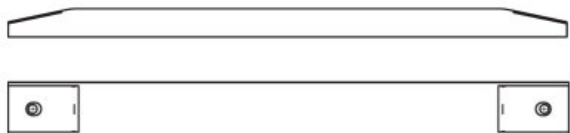

OT SLIM 60

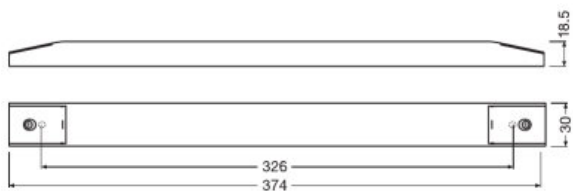

OT SLIM 100

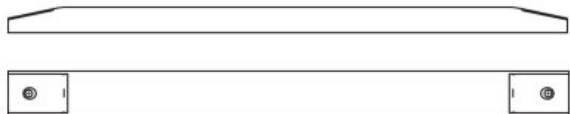

OT SLIM 100

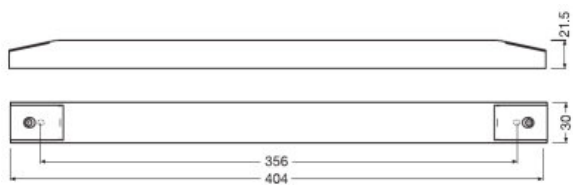

OT SLIM 160



OT SLIM 160

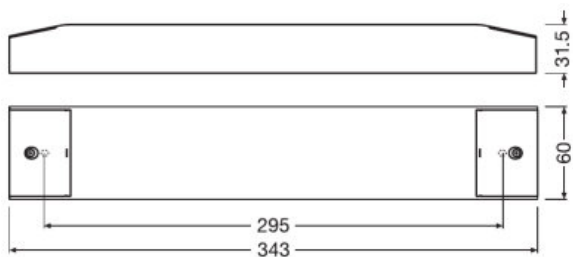

OT SLIM 250

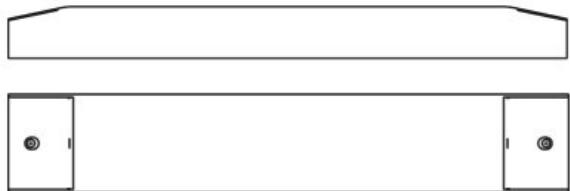

OT SLIM 250

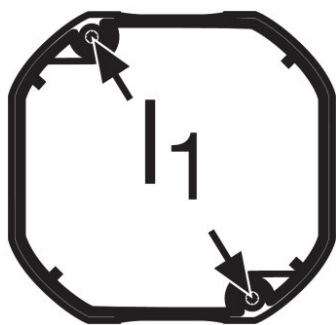

330712_OTROTRONIC OT 6200-24010

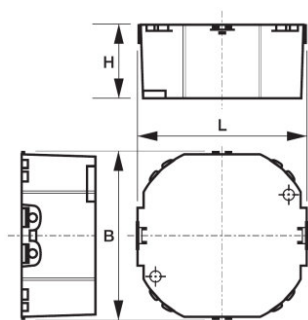

323601_OPTOTRONIC OT 6200-24010

Product family datasheet

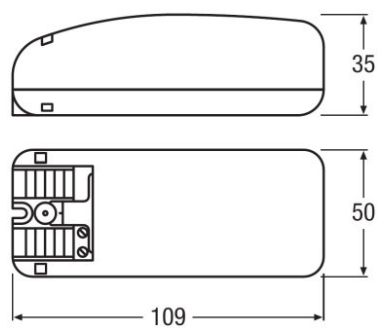

340540_OT 20220-24024

Application advice

For more detailed application information and graphics please see product datasheet.

Additional product information

- EMI pass verified with wire length of 2 m, from the ECG to the LED module at full load.
- Wiring longer than 2 m from ECG to LED module is possible, but site installation conditions may interfere with EMI with these longer cables. EMI is therefore not verified in this condition.
- For wires longer than 2 m, the appropriate cable cross section must be carefully selected to reduce voltage drop.

Sales and Technical Support

Sales and Technical Support www.osram.com



Country specific information

Product description	Product code	METEL code	SEG-No.	STK number	UK Org
OT 6/200...240/24 CE	4008321113269	OSROT624CE	-	4031154	-
OT 6/200...240/24 CE	4008321113269	OSROT624CE	-	4031154	-
OT 20/220...240/24	4050300618111	OSROT2024	-	4031160	-
OT 20/220...240/24	4050300618111	OSROT2024	-	4031160	-





Download Data

File

Product family datasheet

	User instruction OT SLIM
	Product Datasheet OT SLIM 30220-24024 Technical Datasheet (EN)
	Declarations of conformity OT SLIM 30 60 CE 4200563 110320
	CAD data OT SLIM 30 STEP 290420
	Product Datasheet OT SLIM 60220-24024 Technical Datasheet (EN)
	CAD data OT SLIM 60 STEP 290420
	Product Datasheet OT SLIM 100220-24024 Technical Datasheet (EN)
	Declarations of conformity OT SLIM 100 160 250 CE 4205404 310320
	CAD data OT SLIM 100 STEP 290420
	Product Datasheet OT SLIM 160220-24024 Technical Datasheet (EN)
	CAD data OT SLIM 160 STEP 290420
	Product Datasheet OT SLIM 250220-24024 Technical Datasheet (EN)
	Certificates OT SLIM RCM NSW28298 280720
	CAD data PDF OT SLIM 250 STEP 290420
	User instruction OPTOTRONIC CONSTANT VOLTAGE
	Addon Technical Information 313236_ADDON TECHNICAL INFO OT 6200-24010 CE VS20 and OT 6200-24024 CE VS20 (GB)
	Brochures OPTOTRONIC constant-voltage LED power supplies and controls (EN)
	Brochures 730792_Light is universal - Easy installation of efficient complete systems (DE)
	Brochures 730791_Light is universal - Easy installation of efficient complete systems (EN)
	Certificates OT ENEC 40038447 210721
	Declarations of conformity 334859_Declaration of conformity – OT 6200-24010 CE
	Declarations of conformity EU Declaration of Conformity 3578669
	CAD data 3-dim 313445_51x52x22 9900045

Product family datasheet

	CAD data 3-dim 313473_51x52x22 9900045
	CAD data PDF 313405_51x52x22 9900045
	User instruction OPTOTRONIC LED Power Supply
	Addon Technical Information 313233_ADDON TECHNICAL INFORMATION OT 20230-24024 VS20 OSRAM (GB)
	Declarations of conformity 334871_Declaration of conformity – OT 20220-24024

Ecodesign regulation information:

Intended for use with LED modules.

The forward voltage of the LED light source shall be within the defined operating window of the control gear in all operating conditions including dimming if applicable.

Separate control gear and light sources must be disposed of at certified disposal companies in accordance with Directive 2012/19/EU (WEEE) in the EU and with Waste Electrical and Electronic Equipment (WEEE) Regulations 2013 in the UK. For this purpose, collection points for recycling centres and take-back systems (CRSO) are available from retailers or private disposal companies, which accept separate control gear and light sources free of charge. In this way, raw materials are conserved and materials are recycled.

Logistical Data

Product code	Product description	Packaging unit (Pieces/Unit)	Dimensions (length x width x height)	Volume	Gross weight
4062172135733	OT SLIM 30/220-240/24	Shipping carton box 50	315 mm x 282 mm x 145 mm	12.88 dm ³	6453.00 g
4062172135856	OT SLIM 60/220-240/24	Shipping carton box 30	350 mm x 192 mm x 145 mm	9.74 dm ³	5560.00 g
4062172135870	OT SLIM 100/220-240/24	Shipping carton box 30	387 mm x 192 mm x 150 mm	11.15 dm ³	7058.00 g
4062172135894	OT SLIM 160/220-240/24	Shipping carton box 30	417 mm x 192 mm x 165 mm	13.21 dm ³	8996.00 g
4062172135917	OT SLIM 250/220-240/24	Shipping carton box 10	357 mm x 312 mm x 100 mm	11.14 dm ³	9236.00 g
4008321113269	OT 6/200...240/24 CE	Shipping carton box 20	328 mm x 76 mm x 138 mm	3.44 dm ³	1212.50 g
4050300618111	OT 20/220...240/24	Shipping carton box 20	270 mm x 105 mm x 229 mm	6.49 dm ³	2396.00 g

The mentioned product code describes the smallest quantity unit which can be ordered. One shipping unit can contain one or more single products. When placing an order, for the quantity please enter single or multiples of a shipping unit.

Disclaimer

Subject to change without notice. Errors and omission excepted. Always make sure to use the most recent release.