

ESSVG 32 EMV-Z

EMC Pressure compensation cable gland, stainless steel 1.4305, M32

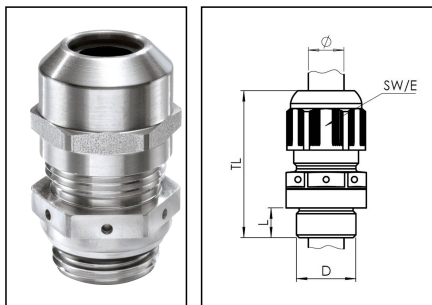

Products may differ in size, colour and appearance to those shown. If you require further information or customisation, please contact us directly.



| | |
|--------------------------------|-----------------------|
| Material cable gland | Edelstahl A2 (1.4305) |
| Material membrane | ePTFE |
| Material sealing gasket | EPDM |
| Material earthing insert | Brass chromium-plated |
| Airflow at 70mbar | 115 l/h |
| Temp. range min | -40 °C |
| Temp. range max | 100 °C |
| Protection class | IP68 / IP69 |
| Thread type | M |
| Ø Connection thread D | 32 |
| Lead | 1,5 |
| Length screw-in thread L | 8 mm |
| Ø cable diameter min | 13 mm |
| Ø cable diameter max | 21 mm |
| Ø cable UL certificate | 14,6 mm - 19,5 mm |
| Ø cable below cable shield max | 20 mm |
| Key width SW | 36 mm |
| Collar diameter (E) | 40 mm |
| Install. torques fitting | 20 N m |
| Install. torques cap nut | 20 N m |
| Total length TL | 47 mm - 56 mm |
| WISKA-Order no. | 10069408 |
| Type | ESSVG 32 EMV-Z |
| Packing unit | 1 |
| ETIM-Classification | EC000441 |

Your Contact:

WISKA Hoppmann GmbH

Kisdorfer Weg 28 · 24568 Kaltenkirchen · Germany

☎ +49-4191-508-0 · 📠 +49-4191-508-209

contact@wiska.de · www.wiska.com

Recommended accessories

| | |
|----------------|----------|
| RDE 32 | 10062186 |
| BS 21 | 10064014 |
| ESMU 32 | 10064192 |

24.08.2021

Your Contact:

WISKA Hoppmann GmbH

Kisdorfer Weg 28 · 24568 Kaltenkirchen · Germany

 +49-4191-508-0 ·  +49-4191-508-209

contact@wiska.de · www.wiska.com

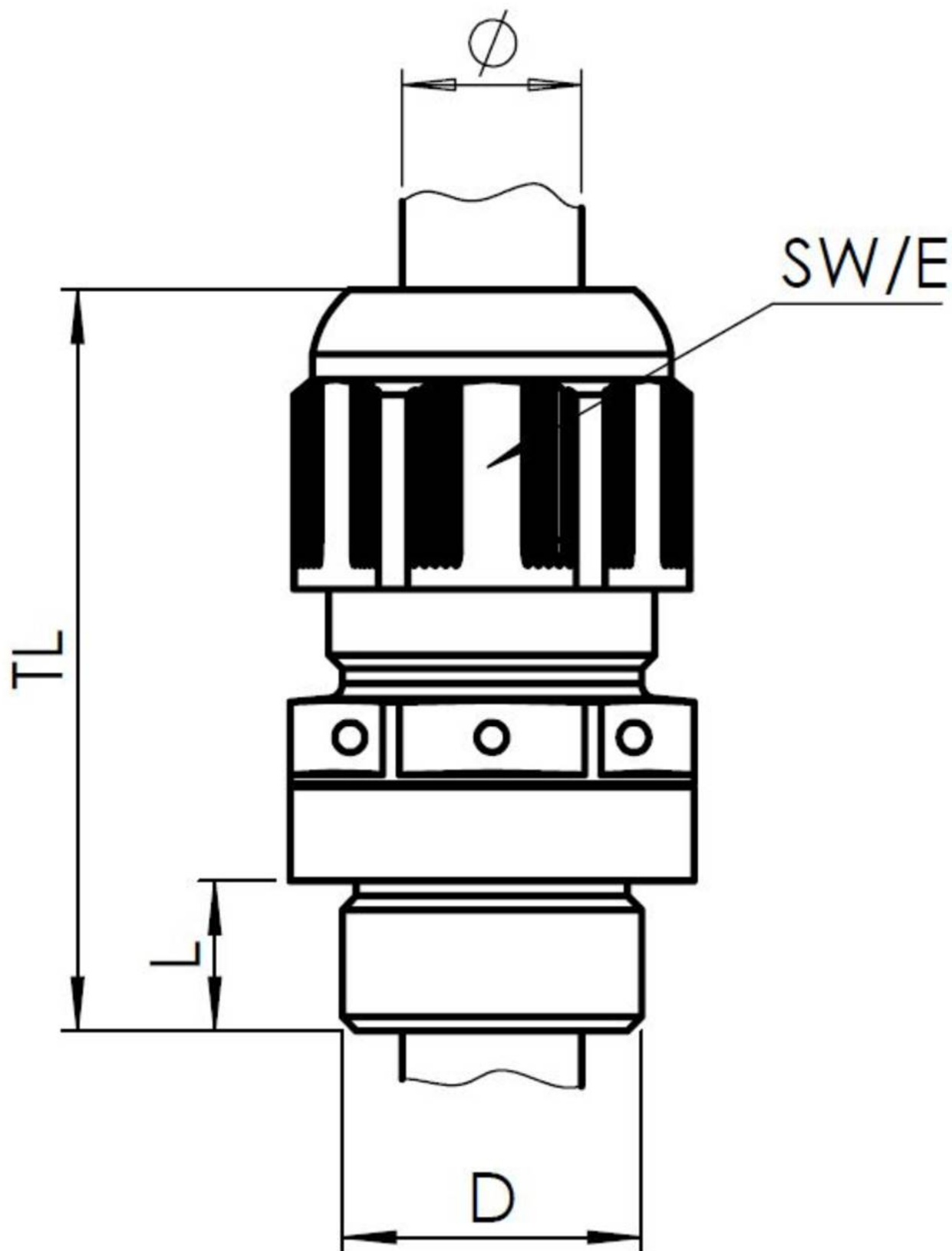

Your Contact:

WISKA Hoppmann GmbH

Kisdorfer Weg 28 · 24568 Kaltenkirchen · Germany

☎ +49-4191-508-0 · 📠 +49-4191-508-209

contact@wiska.de · www.wiska.com