

## ESSVG-4 32

Pressure compensation cable gland, stainless steel 1.4404, M32

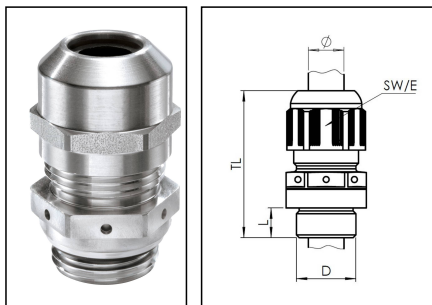

Products may differ in size, colour and appearance to those shown. If you require further information or customisation, please contact us directly.



|                          |                       |
|--------------------------|-----------------------|
| Material cable gland     | Edelstahl A4 (1.4404) |
| Material membrane        | ePTFE                 |
| Material sealing gasket  | EPDM                  |
| Airflow at 70mbar        | 115 l/h               |
| Temp. range min          | -40 °C                |
| Temp. range max          | 100 °C                |
| Protection class         | IP68 / IP69           |
| Thread type              | M                     |
| Ø Connection thread D    | 32                    |
| Lead                     | 1,5                   |
| Length screw-in thread L | 8 mm                  |
| Ø cable diameter min     | 13 mm                 |
| Ø cable diameter max     | 21 mm                 |
| Ø cable diameter UL      | 14,6 mm - 19,5 mm     |
| Key width SW             | 36 mm                 |
| Collar diameter (E)      | 40 mm                 |
| Install. torques fitting | 20 N m                |
| Install. torques cap nut | 20 N m                |
| Total length TL          | 47 mm - 56 mm         |
| WISKA-Order no.          | 10069502              |
| Type                     | ESSVG-4 32            |
| Packing unit             | 1                     |
| ETIM-Classification      | EC000441              |

Your Contact:

WISKA Hoppmann GmbH

Kisdorfer Weg 28 · 24568 Kaltenkirchen · Germany

☎ +49-4191-508-0 · 📠 +49-4191-508-209

contact@wiska.de · www.wiska.com

**Recommended accessories**

|                             |          |
|-----------------------------|----------|
| <b>RDE 32</b>               | 10062186 |
| <b>BS 21</b>                | 10064014 |
| <b>ESMU 32</b>              | 10064192 |
| <b>MFD 32/04/070</b>        | 10064344 |
| <b>MFD 32/06/060</b>        | 10064345 |
| <b>MFD 32/04/080</b>        | 10064950 |
| <b>MFD 32/03/080</b>        | 10101018 |
| <b>MFD 32/05/070</b>        | 10101140 |
| <b>MFD 32/01/115-01/085</b> | 10101256 |
| <b>MFD 32/03/065</b>        | 10102169 |
| <b>MFD 32/03/090</b>        | 10102170 |

17.06.2021

Your Contact:

**WISKA Hoppmann GmbH**

Kisdorfer Weg 28 · 24568 Kaltenkirchen · Germany

 +49-4191-508-0 ·  +49-4191-508-209

contact@wiska.de · www.wiska.com

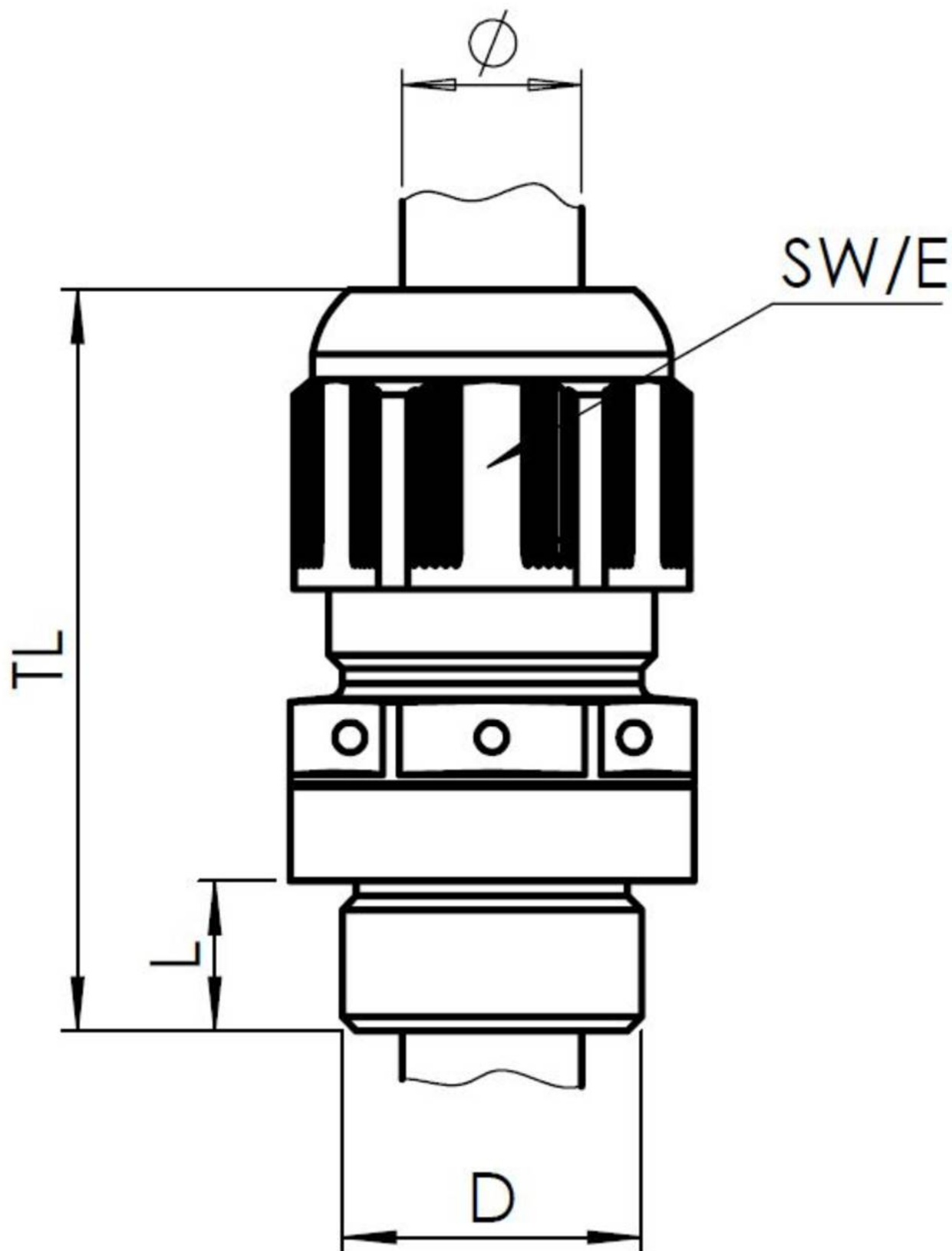

Your Contact:

**WISKA Hoppmann GmbH**

Kisdorfer Weg 28 · 24568 Kaltenkirchen · Germany

☎ +49-4191-508-0 · 📠 +49-4191-508-209

contact@wiska.de · www.wiska.com