

ESSVG-4 25

Pressure compensation cable gland, stainless steel 1.4404, M25

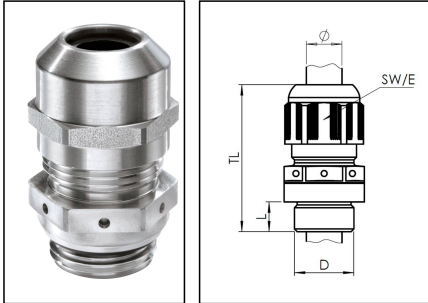

Products may differ in size, colour and appearance to those shown. If you require further information or customisation, please contact us directly.





| | |
|--------------------------|-----------------------|
| Material cable gland | Edelstahl A4 (1.4404) |
| Material membrane | ePTFE |
| Material sealing gasket | EPDM |
| Airflow at 70mbar | 90 l/h |
| Temp. range min | -40 °C |
| Temp. range max | 100 °C |
| Protection class | IP68 / IP69 |
| Thread type | M |
| Ø Connection thread D | 25 |
| Lead | 1,5 |
| Length screw-in thread L | 7 mm |
| Ø cable diameter min | 9 mm |
| Ø cable diameter max | 17 mm |
| Ø cable diameter UL | 10,8 mm - 15,8 mm |
| Key width SW | 30 mm |
| Collar diameter (E) | 33 mm |
| Install. torques fitting | 10 N m |
| Install. torques cap nut | 10 N m |
| Total length TL | 43 mm - 52 mm |
| WISKA-Order no. | 10069501 |
| Type | ESSVG-4 25 |
| Packing unit | 1 |
| ETIM-Classification | EC000441 |

Your Contact:

WISKA Hoppmann GmbH

Kisdorfer Weg 28 · 24568 Kaltenkirchen · Germany

☎ +49-4191-508-0 · 📠 +49-4191-508-209

contact@wiska.de · www.wiska.com

Recommended accessories

| | |
|-----------------------------|----------|
| MFD 25/02/060 | 10060452 |
| RDE 25 | 10060768 |
| MFD 25/02/080 | 10060952 |
| MFD 25/01/065 | 10060954 |
| MFD 25/02/070 | 10063995 |
| BS 17 | 10064012 |
| ESMU 25 | 10064191 |
| MFD 25/03/070 | 10064342 |
| MFD 25/04/060 | 10064343 |
| MFD 25/01/090 | 10101016 |
| MFD 25/01/105-01/055 | 10101255 |
| MFD 25/05/056 | 10102023 |

17.06.2021

Your Contact:

WISKA Hoppmann GmbH

Kisdorfer Weg 28 · 24568 Kaltenkirchen · Germany

☎ +49-4191-508-0 · 📠 +49-4191-508-209

contact@wiska.de · www.wiska.com

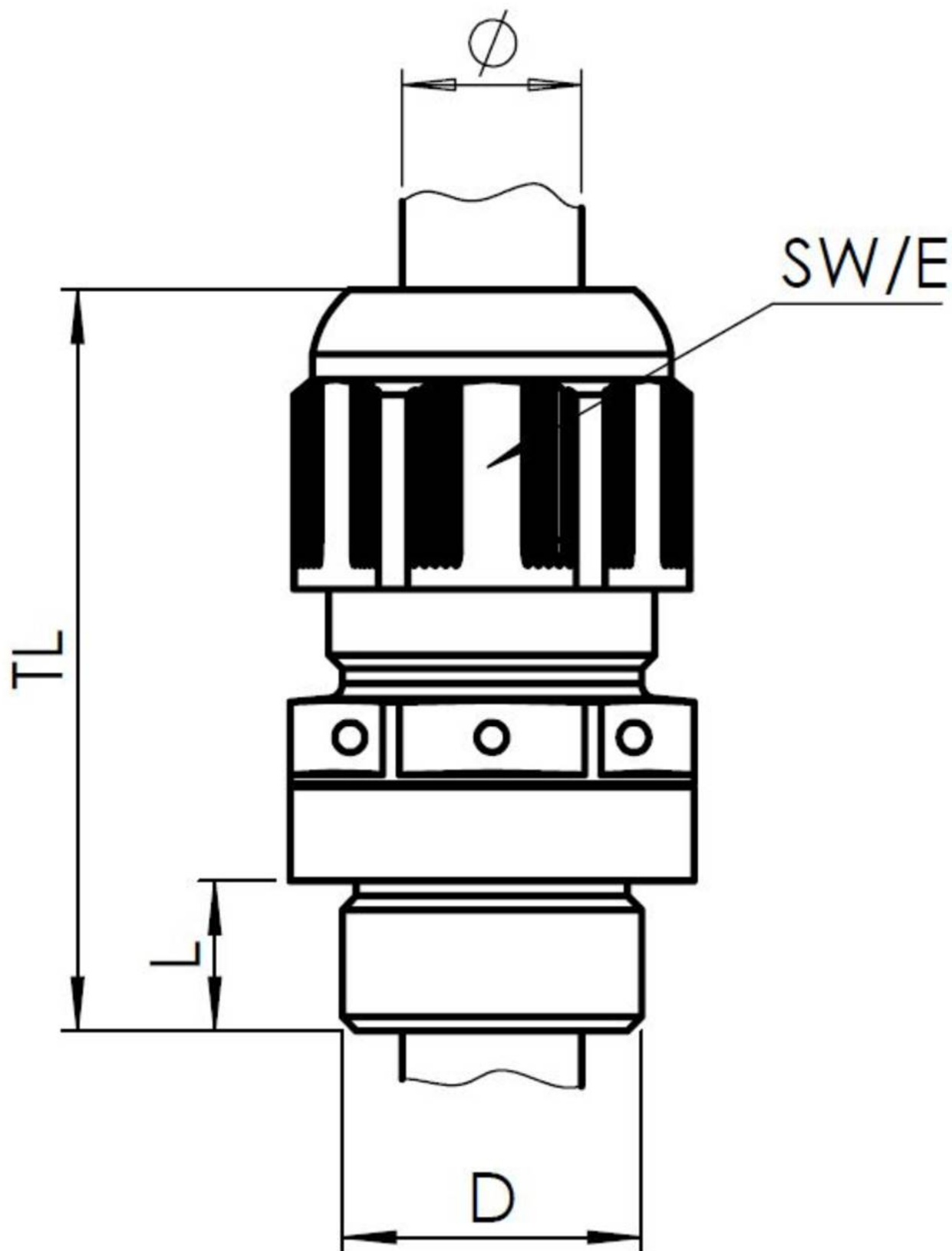

Your Contact:

WISKA Hoppmann GmbH

Kisdorfer Weg 28 · 24568 Kaltenkirchen · Germany

☎ +49-4191-508-0 · 📠 +49-4191-508-209

contact@wiska.de · www.wiska.com