

## KVG 36

Cone cable gland, polyamide, Pg 36, RAL 7035

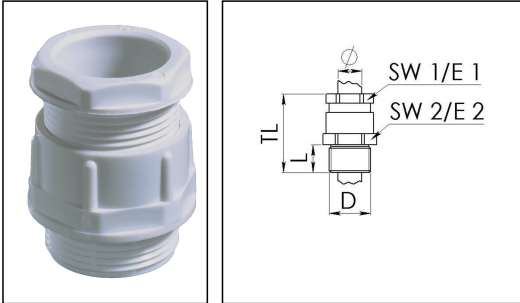

Products may differ in size, colour and appearance to those shown. If you require further information or customisation, please contact us directly.



Material cable gland	Polyamide, fibre reinforced
Protection class	IP54
Temp. range min	-20 °C
Temp. range max	80 °C
Thread type	PG
Ø Connection thread D	36
Length screw-in thread L	13 mm
Ø cable diameter min	25 mm
Ø cable diameter max	32 mm
Key width SW1	50 mm
Key width SW2	53 mm
Collar diameter E1	54 mm
Collar diameter E2	57 mm
Total length TL	54 mm
Product Color	RAL 7035
Type	KVG 36
Order no. RAL 7035	10060148
Packing unit	10
ETIM-Classification	EC000441

### Recommended accessories

MUG 36	10060677
ADR 36	10061426

Your Contact:

WISKA Hoppmann GmbH

Kisdorfer Weg 28 · 24568 Kaltenkirchen · Germany

☎ +49-4191-508-0 · 📠 +49-4191-508-209



contact@wiska.de · www.wiska.com

09.05.2021

Your Contact:

**WISKA Hoppmann GmbH**

Kisdorfer Weg 28 · 24568 Kaltenkirchen · Germany

 +49-4191-508-0 ·  +49-4191-508-209

[contact@wiska.de](mailto:contact@wiska.de) · [www.wiska.com](http://www.wiska.com)

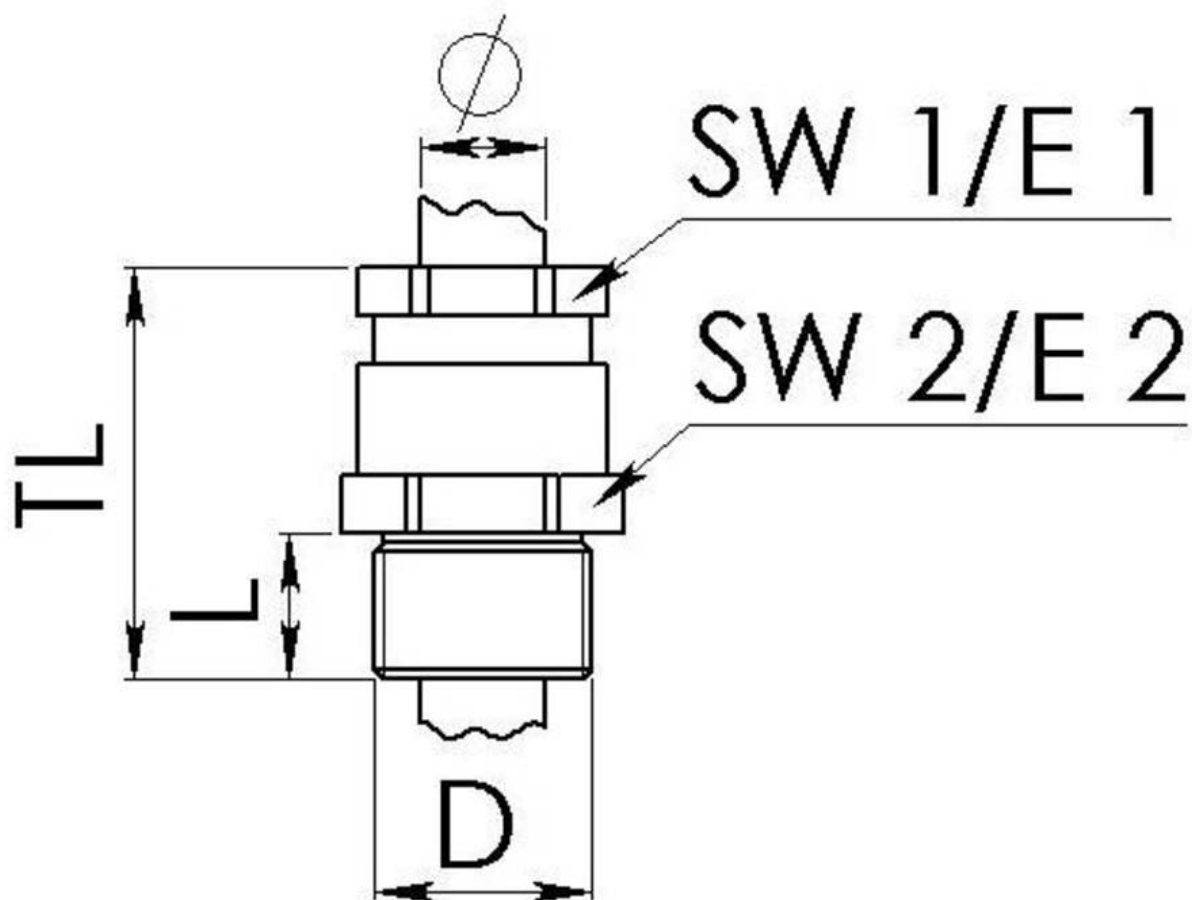

Your Contact:

**WISKA Hoppmann GmbH**

Kisdorfer Weg 28 · 24568 Kaltenkirchen · Germany

☎ +49-4191-508-0 · 📠 +49-4191-508-209

contact@wiska.de · www.wiska.com